



Kaya Embira 15ABC, Tera Cora

US\$ 770,000 Asking price

Buyers Costs

Tera Cora - 2,443 / 227 sq.ft./m2 - 8 Bedrooms - 5 Baths

Real Estate information

Neighborhood	Tera Cora
Address	Kaya Embira 15ABC
Freehold Land	
Bedrooms	8
Bathrooms	5
Parking	
Walk-in Closet	
Air Conditioning in bedrooms	
Total living area	2,443 / 227 sq.ft./m2
Total ground area	7,104 / 660 sq.ft./m2
Construction date	2019
Maintenance status	good



Ground tax (annually): 0.345% of the value (1st residence), or Property tax (annually): 0.91% of the value (2nd residence). Buyers Costs consist of (one-off): 5% transfer tax, approx. 2% notary costs and costs of Land Registry at the office of Kadaster depending on purchase price.

Registered at the Land Registry Office
Kadaster, number 4-G-3699



Features

If you are looking for the perfect investment opportunity, Kaya Embira 15ABC is exactly what you are looking for! Ideally located near Kralendijk, supermarkets and schools, you will find this small scale apartment building in the popular Nikiboko district. This two storey building consists of 4 spacious apartments. The apartments on the ground floor have a terrace and a garden, the apartments on the second floor both have their own balcony.

The perfect location combined with the comfort and privacy that the apartments offer make these apartments very popular as long-term rental.

- Building with 4 apartments,
- Great long term rental possibilities
- 3 minutes by car to the center of Kralendijk,
- All floors have polished concrete,
- Aluminum window frames with glass panels and screens,
- Parking on site.

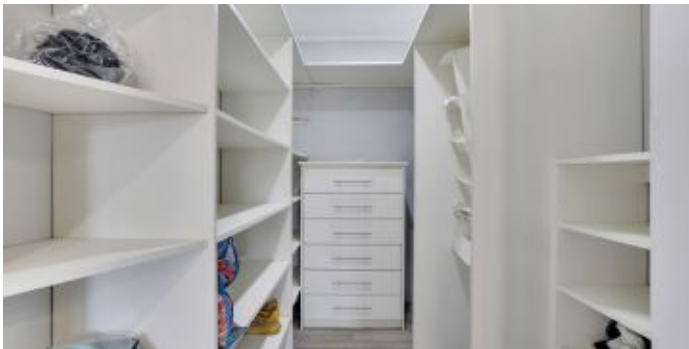

Lay Out

- 1 unit on the ground floor holds a living room, kitchen, 3 bedrooms, 3 bathrooms, covered porch and garden,
- 1 unit on the ground floor holds a living room, kitchen, 2 bedrooms, 1 bathroom, covered porch and a garden,
- 2 units on the second floor hold a living room, kitchen, 1 bedroom, 1 bathroom and a covered porch,

Technical specifications

- 110 & 220 Volts
- Pagabon (prepaid) electricity connection per unit
- split unit air conditioning in all bedrooms.

Living area is based on net indoor space plus covered outdoor space.

Zoning plan

Extract from Ruimtelijk Ontwikkelingsplan Bonaire (zoning plan)

Link to zoning plan map with marker: [Map](#)

Link to zoning description: [Zoning "Woongebied - I"](#)





▼ Ground Floor

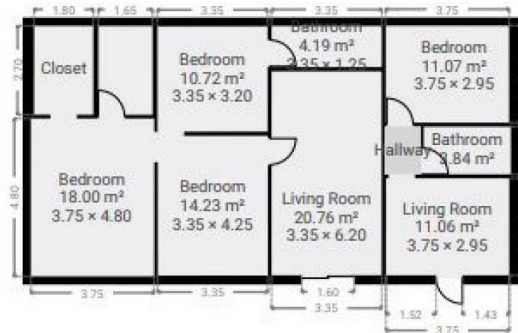

▼ 1st Floor

